

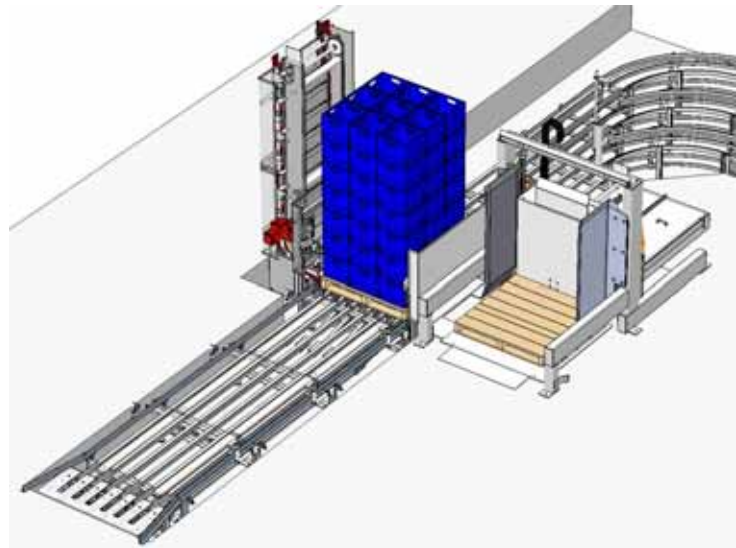

Contact: Laura Worker
Marketing Manager
Westfalia Technologies, Inc.
717.764.1115, ext. 111
lworker@westfaliaUSA.com



For immediate release

NEW Empty Case De-Palletizing System from Westfalia Deam
De-Palletizes Over 3 Pallets of Empty Cases per Minute

YORK, Pa., February 11, 2011 – The newly designed compact Plastic Case Stack De-Palletizing System from Westfalia Deam Systems de-palletizes 3-4 dairy pallets (40" x 40") per minute, each with 9 stacks of empty plastic dairy cases, for a maximum throughput rate of 180 cases per minute. Capable of handling stacks palletized, unitized, or a combination of both, the De-Palletizer design utilizes a clamp and lift technology unlike a stack pusher typical of other de-palletizing systems. This clamp & lift technology maintains full stack control, eliminating stack tipping, which is a major concern for users. All components of the system are constructed



of stainless steel materials making this compact Case De-Palletizing System ideally suited to the wash-down environments found in the dairy, beverage and bakery industries where uniform plastic case stacks are handled.

This de-Palletizing clamping technology clamps the stacks from the side discharges the empty pallet to an automatic pallet stacker. The side clamps

are released and the stacks are gently placed onto chain conveyors. The stacks then travel to a 3 to 1 merge zone and are single lane released to Westfalia Deam De-stacking units capable of handling 12 stacks per minute.

With its modular construction this De-Palletizing system can be installed quickly and easily into existing empty case receiving areas. Its compact design utilizes a smaller building footprint (approximately 10'x15'), saving space for other dairy needs. The Allen Bradley PLC controls offer Ethernet connectivity and a color HMI (Human Machine Interface) touch screen to provide operators with the latest operating data including diagnostics and error messaging. The entire



system, including PLC panels and HMI are IP65 rated for wash down.

Westfalia's De-Palletizing System handles 16 quart plastic cases on a typical 40" x 40" dairy pallet. With 16 quart cases stacked in a 3 x 3 pattern on a pallet, 27+ stack groups can be de-palletized per minute. For dairies handling only unitized loads, a reduced system with only the chain

conveyors, the 3 to 1 merge unit, and the de-stacker would be required. The system is safety protected with a surround safety fence with light curtains on pallet entry points, stack discharge and empty pallet discharge.

As with all Westfalia products, the Empty Case De-Palletizing System is thoroughly tested (Factory Automation Tests) before shipping and installation at a client's facility. The system is guaranteed to perform to specifications. Westfalia also offers a complete service / maintenance plan on all equipment to guarantee your peace of mind.

This Case De-Palletizer System is only part of the complete line of beverage case packing and case handling equipment available from Westfalia Deam Systems' division. To learn more about the full product line, including case packers, case stackers, conveyors, inverters and

more, please contact Westfalia at 800-673-2522, 717-764-1115 or visit www.WestfaliaUSA.com and click on our case packing and handling products.

About Westfalia Deam Systems (www.WestfaliaUSA.com)

Westfalia Deam Systems is the result of merging Deam Limited of Toronto, Canada, with Westfalia Technologies, Inc. of York, Pennsylvania in 2006. It is known throughout the industry for innovative, compact, custom designed case packing and handling equipment for the dairy and beverage industries. With a full team of mechanical, electrical and software engineers in-house, Westfalia designs beverage casing and handling systems to meet each client's specific needs. To learn more about Westfalia's products, including Case Packing and Case Handling Systems, Automated Storage and Retrieval Systems (AS/RS) and *Savanna*.NET® Warehouse Management Systems, please visit our website www.WestfaliaUSA.com or call 800-673-2522.

###